



Errezero the fiberglass sandwich panel for clima food

**Errezero is the best solution for
the hygiene and safety of the
environments for food production**

- Resistant to mold and microorganisms
- Salt resistant
- Economic and light
- Stable and long-lasting (deformation / color)
- Easy installation

www.cosmaimpianti.it

Cosma Impianti Srl - T. 0423.755533





Errezero advantages

Joint MFG



Male-Female coupling with Hook (MFG) consists of simply bringing the panels together and subsequent fixing with eccentric hooks embedded in polyurethane (variable pitch with min. 400 mm). The hooks consist of a plastic shell and a cam closing mechanism in galvanised steel.

The cam is actuated by inserting the special hex wrench in the holes in the panel sheet; the holes are closed with plastic caps after assembly.

The seal and the tightness of the joint is ensured by gaskets to be fitted during assembly. This type of joining significantly reduces the time required for panel assembly operations

Detail of soft joint cover

Errezero technical sheet

Description	U/M							
	mm	60	80	100	120	150	200	240
Panel thickness	mm	60	80	100	120	150	200	240
Mass	Kg/m ²	7,40	8,20	9,0	9,8	11,0	13,0	14,6
Densità PUR - PIR	Kg/m ²	40 +/- 5%						
Thermal conductivity λ	W/mK	0,023						
Thermal conductivity (λ aged value)	W/m ² K	0,39	0,29	0,24	0,20	0,16	0,12	0,10
Tensile strength	Mpa	0,15						
Compressive strength	Mpa	0,17						
Water vapour permeability		Impermeable						
Fire reaction		NPD						
Characteristics of polyurethane foam		Foaming agent HFC134a						
		Closed cell content >90%						
Pitch	mm	1190						
Maximum length of straight section	mm	13600						
Skins		Material: polyester laminate						
		Surface: smooth matte						
		Standard color: RAL 9010						
		Thickness: 2 mm						

Air permeability

our panel joints have a 5 times higher thermodynamic efficiency than the dry joints

The panels used to build the cold rooms are our exclusive production and are designed for specific use in the refrigeration sector: our panel joints have a 5 times higher thermodynamic efficiency than the continuous products, as demonstrated by the tests performed at the ITC-CNR Institute in Milan. The complete test reports are available at the headquarters of Cosma Impianti and upon request can be consulted during visits by our sales representatives.

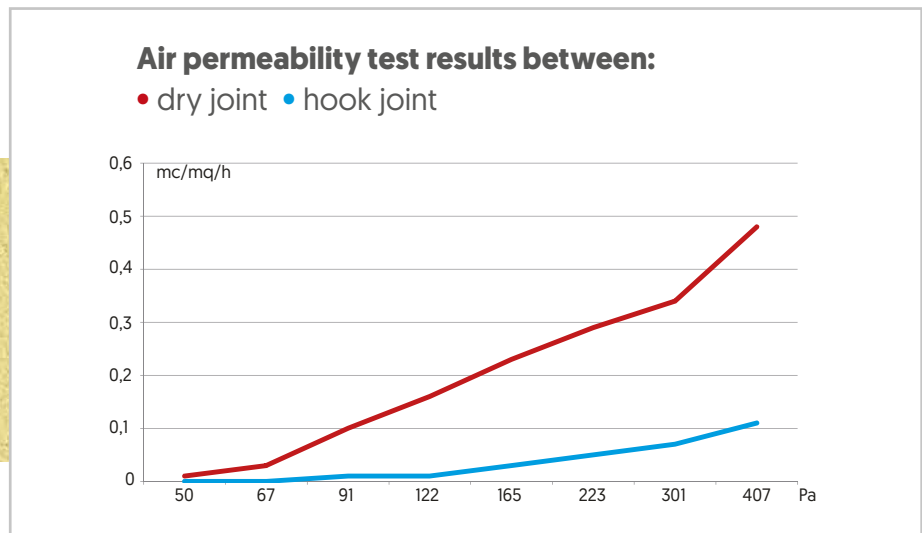

Dry joint

Hook joint

In the section you will notice like the dry joint allow passage of the air, while the MFG hook joint of Cosma Impianti guarantees impermeability to air thanks to his construction features:

 Labyrinth joint

 ABS joint

 Joint cover in Soft PVC

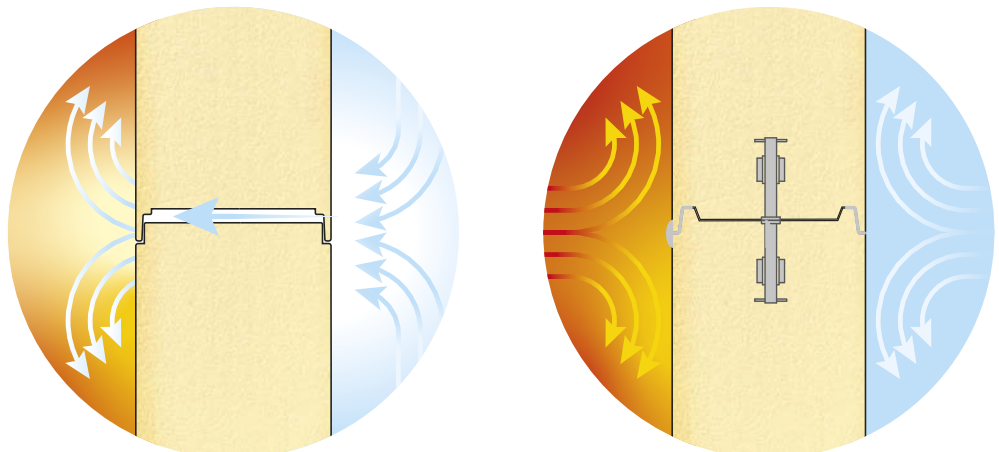



“Made-to-measure” capability

Every job we do is unique, carefully crafted to efficiently fulfil our customers' specific needs.



Professionalism

From the designers to the assemblers, our close-knit team is made up exclusively of in-house, highly qualified personnel.



Innovation

Every project is the sum of the components and solutions created to deliver the highest performance in terms of efficiency, ergonomics and aesthetics.



Experience

We have been collaborating with customers for over thirty years all over the world, constantly learning to our bring new elements to the next project.



Total management

Feasibility analysis, design, component production, installation, commissioning and final testing; we manage all the stages of the project.



Certification

Cosma Impianti is a UNI EN ISO 9001 certified company. Our panels have obtained CE marking [UNI EN 14509].